

NO.	SIGNAL		
1	NC	27	DG2
2	VDD3	28	DG3
3	VDD3	29	DG4
4	NC	30	DG5
5	VDD1	31	DG6
6	NC	32	DG7
7	PCLK	33	GND
8	DE	34	DR0
9	HSYNC	35	DR1
10	VSYNC	36	DR2
11	NC	37	DR3
12	SDI	38	DR4
13	CSX	39	DR5
14	SCL	40	DR6
15	GND	41	DR7
16	DB0	42	GND
17	DB1	43	RESET
18	DB2	44	CABC_PWM
19	DB3	45	NC
20	DB4	46	LED2-
21	DB5	47	LED1-
22	DB6	48	NC
23	DB7	49	LED2+
24	GND	50	LED1+
25	DG0	51	GND
26	DG1		

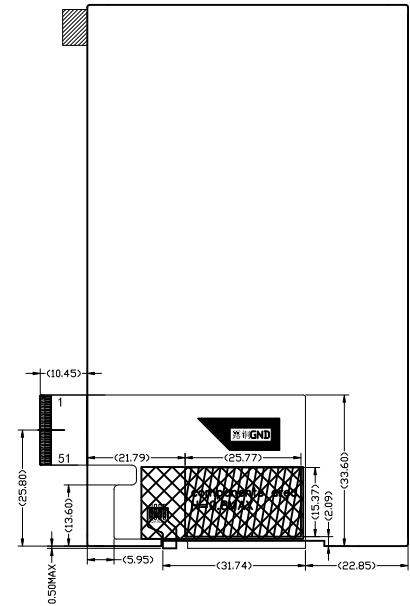

FPC unfolded shipment  
Folded View

- NOTE:
- GENERAL TOLERANCE: ±0.2.
  - (...) IS REFERENCE DIMENSION.
  - \* CRITICAL DIMENSION
  - COMPLIABLY RoHS.
  - FPC CONNECTOR: ZIF(FH26-51S-0.3SHW)

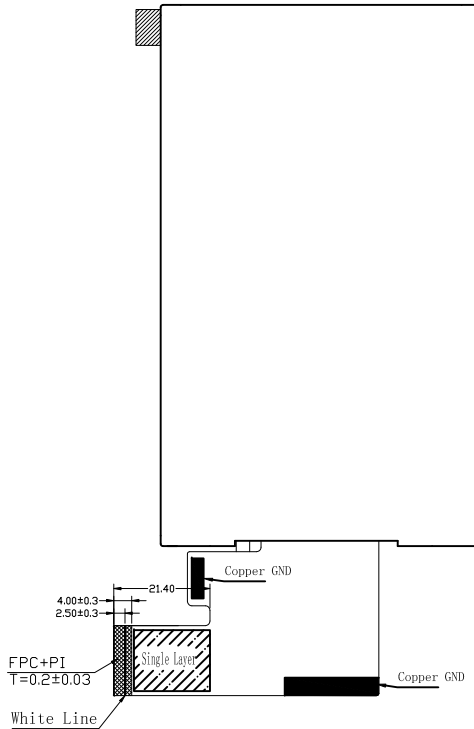
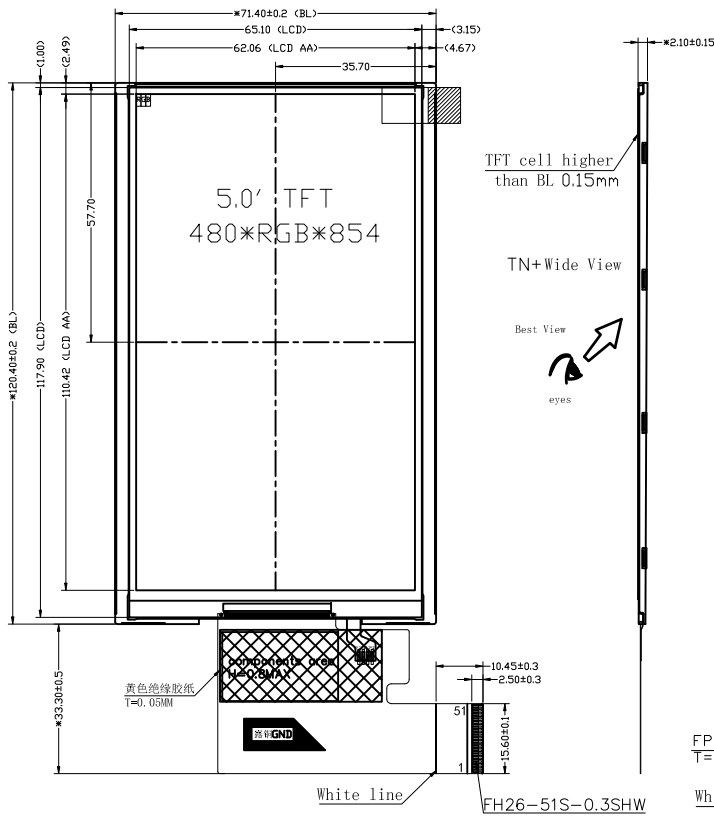

B/L CIRCUIT DIAGRAM

Panel	Display Type	5.0" HSD TFT/TRANSMISSIVE
	Viewing Angle	Best Image Viewing: 6 O'CLOCK
	Driver IC	NT35512
LCM	Interface	SPI+RGB
	Operating Voltage	VDD3=3.0V, VDD1=1.8V
	Luminance	500(TYP.)/400(MIN.)
	Center coordinate	TBD
	Backlight	WHITE(40mA, 17.4V-20.4V)
	Connector type	ZIF(FH26-51S-0.3SHW)
	Operation Temp.	-20°C TO 70°C
	Storage Temp.	-30°C TO 80°C

					DRAWN	LH	TITLE	DRAWING NO.			
					CHECKED		MODULE SPEC.	STG-TF7342DT050			
					APPROVED		BOM NO: BT140619-05	UNIT	mm	SCALE	FIT
01		Issue First		LH	2014.6.25	CUSTOMER'S APPROVAL		3rd Angle		SHEET	1 OF 1
VER.	SYMBOL	AMENDMENT		SIGN	DATE		TRUEVISION TECHNOLOGIES LTD				